

244

FED. ROAD DIST. NO.	STATE	FED. AID PROJ. NO.	FISCAL YEAR	SHEET NO.	TOTAL SHEETS
6	ARK.		1927	1.	5

STATE OF ARKANSAS
STATE HIGHWAY DEPARTMENT

PLAN OF PROPOSED BRIDGE
OVER
GREENBRIER CREEK
BATESVILLE - HEBER SPRINGS ROAD
INDEPENDENCE COUNTY

INDEX OF SHEETS

Drwg. No 343.	Sheet No. 1.	TITLE SHEET.
Drwg. No 340.	Sheet No. 2.	LAYOUT OF BRIDGE OVER GREENBRIER CREEK.
Drwg. No 341.	Sheet No. 3.	DETAILS OF EAST APPROACH.
Drwg. No 59.	Sheet No. 4.	STD. 80'-STEEL TRUSS SPAN.
Drwg. No 342.	Sheet No. 5.	DETAILS OF WEST APPROACH.

QUANTITIES

DRY EXCAVATION	338.2 Cu. Yds
WET EXCAVATION	199.5 Cu. Yds.
ROCK EXCAVATION	26.8 Cu. Yds.
CLASS "A" CONCRETE	173.0 Cu. Yds
CLASS "S" CONCRETE	98.53 Cu. Yds
REINFORCING STEEL	30,578 POUNDS.
STRUCTURAL STEEL (TRUSSES)	60,300 POUNDS
UNTREATED TIMBER PILING	146 LIN. FT
CONCRETE RAILING	110.67 LIN. FT

FEDERAL AID PROJECT No.
ROUTE 25-S4

JOB No. 503

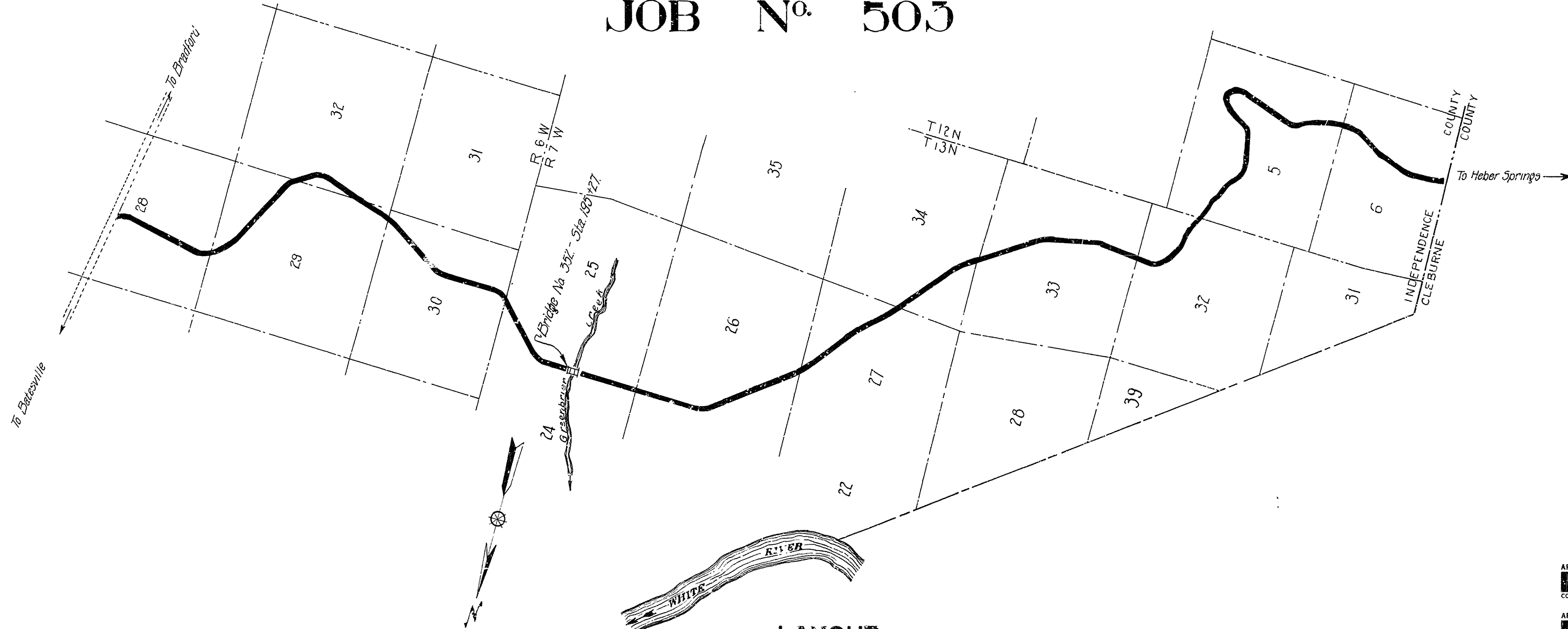

LAYOUT

Scale: 1"=2000'

GROSS LENGTH OF PROJECT = .024 MILES.
NET LENGTH OF PROJECT = .024 MILES.

APPROVED
COMMISSIONER - STATE LARGES HIGHWAYS AND IMPROVEMENTS

APPROVED
STATE HIGHWAY ENGINEER

RECOMMENDED FOR APPROVAL
DISTRICT ENGINEER - U. S. BUREAU OF PUBLIC ROADS

RECOMMENDED FOR APPROVAL
CHIEF ENGINEER - U. S. BUREAU OF PUBLIC ROADS

APPROVED
DIRECTOR - U. S. BUREAU OF PUBLIC ROADS

N. B. Garver
BRIDGE ENGINEER

BRIDGE No. 352. DRWG. No. 343.

FED. AID DIST. NO.	STATE	FED. AID PROJ. NO.	FISCAL YEAR	SHEET NO.	TOTAL SHEETS
6	ARK.				

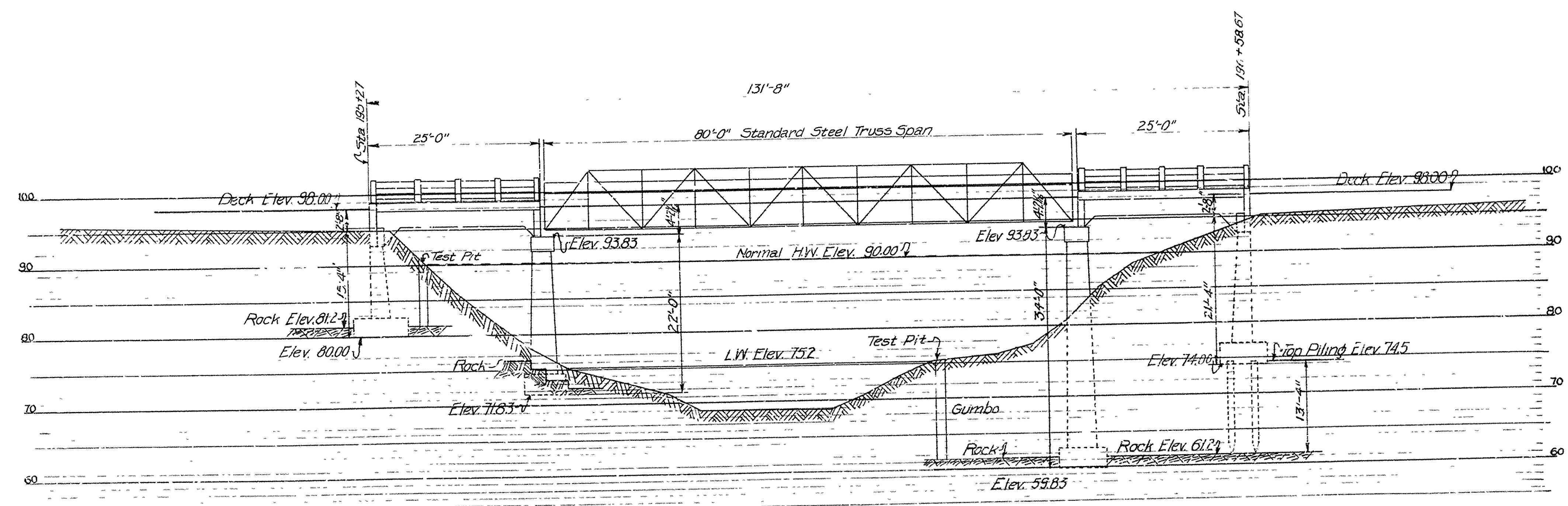
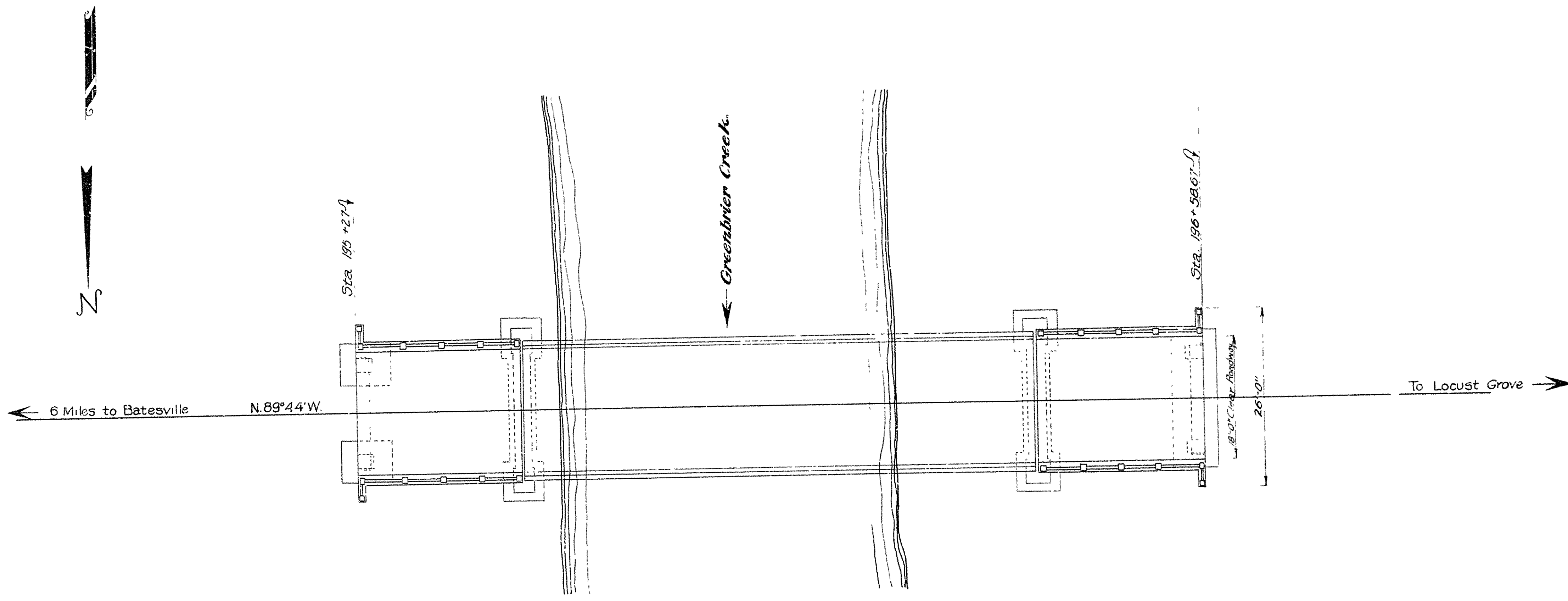

3M-Copper rivet in root of 30" pecan 100'
 L Sta 195+28. Elev. 93.00
 NOTE:- See Drwg Nos. 341 & 342. For Details.

NOTE:- Lengths of Piling shown are assumed for estimated quantities only. Actual length to be determined in the field. Foundation piling to be untreated lumber piling.

LAYOUT OF
 BRIDGE OVER GREENBRIER CREEK.
 6 MILES W. OF BATESVILLE, INDEPENDENCE CO. STATE HWY. NO. 25
 ARKANSAS STATE HIGHWAY DEPARTMENT
 LITTLE ROCK, ARK.
 Designed By M.W.K. Date 9/18/27
 Traced By H.M.K. Date 9/3/27
 Checked By Date
 Bridge No. 352 Scale 1 inch = 10 feet.
 Drawing No. 340

M.W.K.
 BRIDGE ENGINEER

FED. ROAD DIST. NO.	STATE	PROJECT NO.	SHEET NO.	TOTAL SHEETS
C	ARK.			

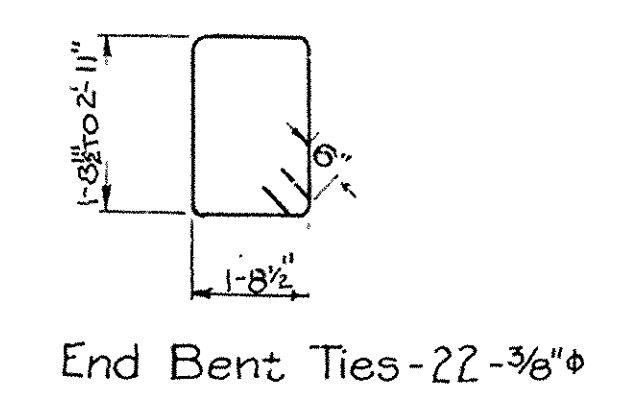
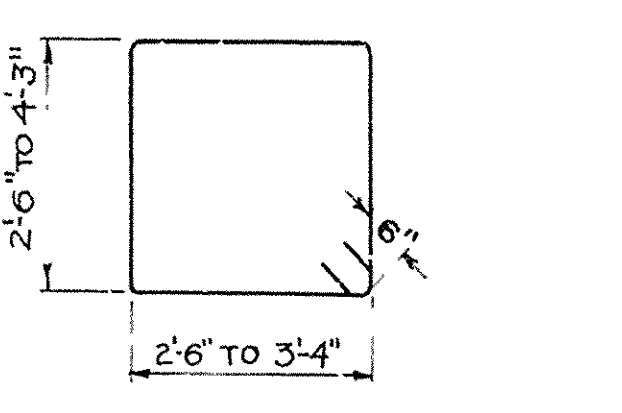
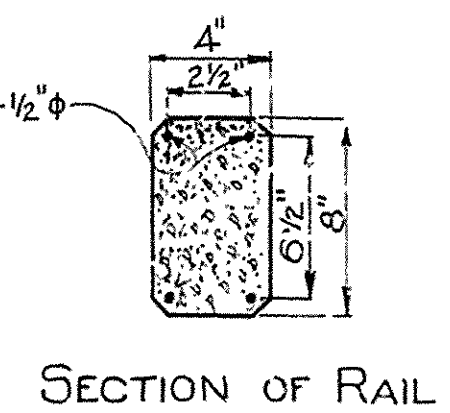
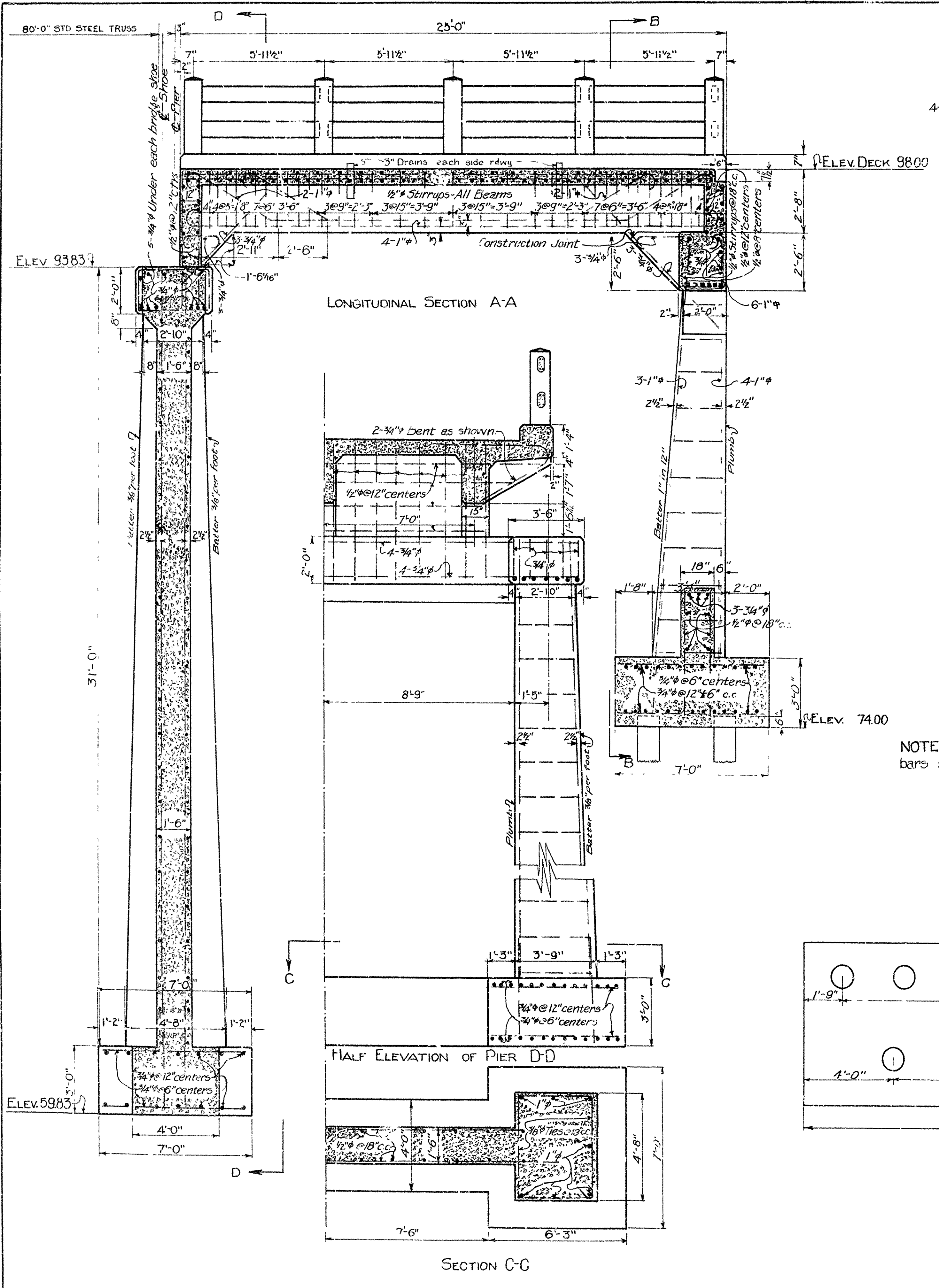

NOTE:- Bending diagrams for remainder of bars shown on Drawing No. 341

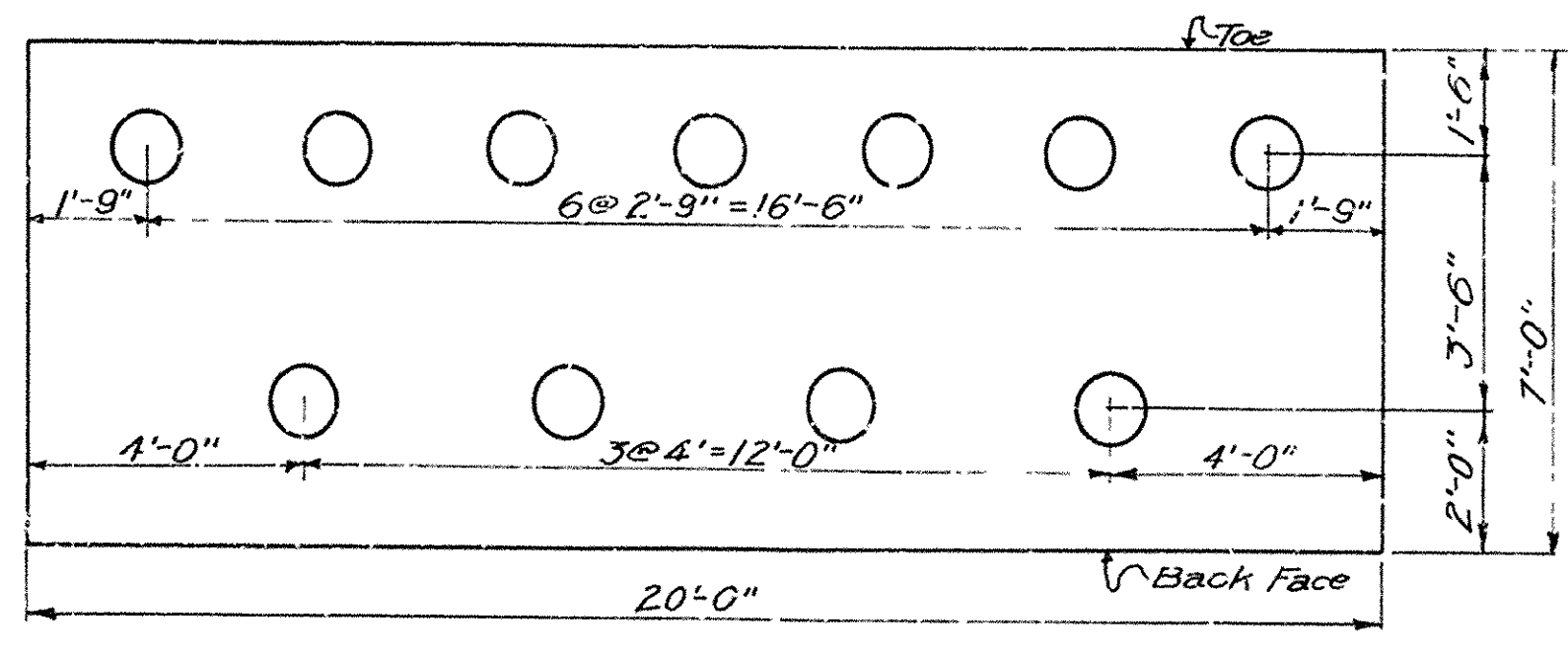
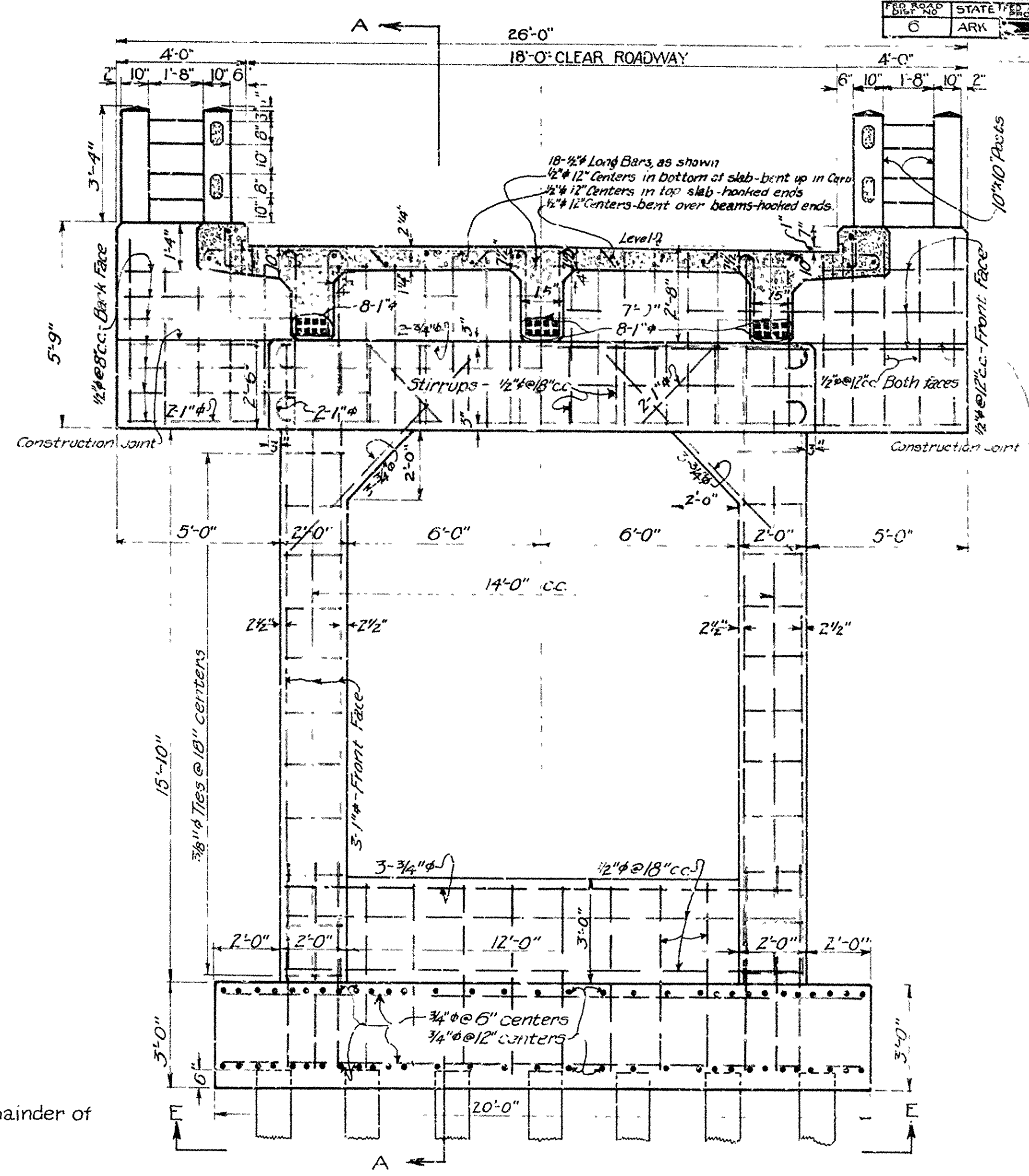

- NOTES:-
- All exposed corners to have 3/4" Chamfer unless otherwise noted.
 - Precast Concrete Handrails to be 1:3 Mix. Max Agg. 1/4"
 - Rail Posts to be Class "S" Concrete
 - Reinforcing Steel to be deformed bars of Structural or Intermediate Grade.
 - Shop List and Bending Diagrams of Reinforcing Steel must be submitted by Contractor before fabrication is begun.
 - Roadway Drains and Expansion Devices to be paid for as Reinforcing Steel.
 - All Concrete above top of Column Caps, except Handrail, to be Class "S" Concrete
 - All Concrete below top of Column Caps, to be Class "A" Concrete
 - All Concrete to be poured in the dry.
 - Foundation Piling to be Untreated Timber.
 - Piling may be omitted if foundation conditions are found satisfactory to the Engineer
 - Specifications:- Arkansas Standard Road and Bridge Specifications adopted May 30th 1925.

DETAILS OF WEST APPROACH
 BRIDGE OVER GREENBRIER CREEK
 6 MILES W OF BATESVILLE INDEPENDENCE CO STATE HIGHWAY NO.25
 ARKANSAS STATE HIGHWAY DEPARTMENT
 LITTLE ROCK, ARK.
 Designed By M.W.K Date: 9-1927
 Traced By M.W.K Date: 9-1927
 Checked By Date:
 Bridge No.352
 Scale: 3/8"=1'
 Drawing No 342.

M.W.K.
 BRIDGE ENGINEER

FED. ROAD DIST. NO.	STATE	PROJ. NO.	FISCAL YEAR	SHEET NO.	TOTAL SHEETS
6	ARK.				

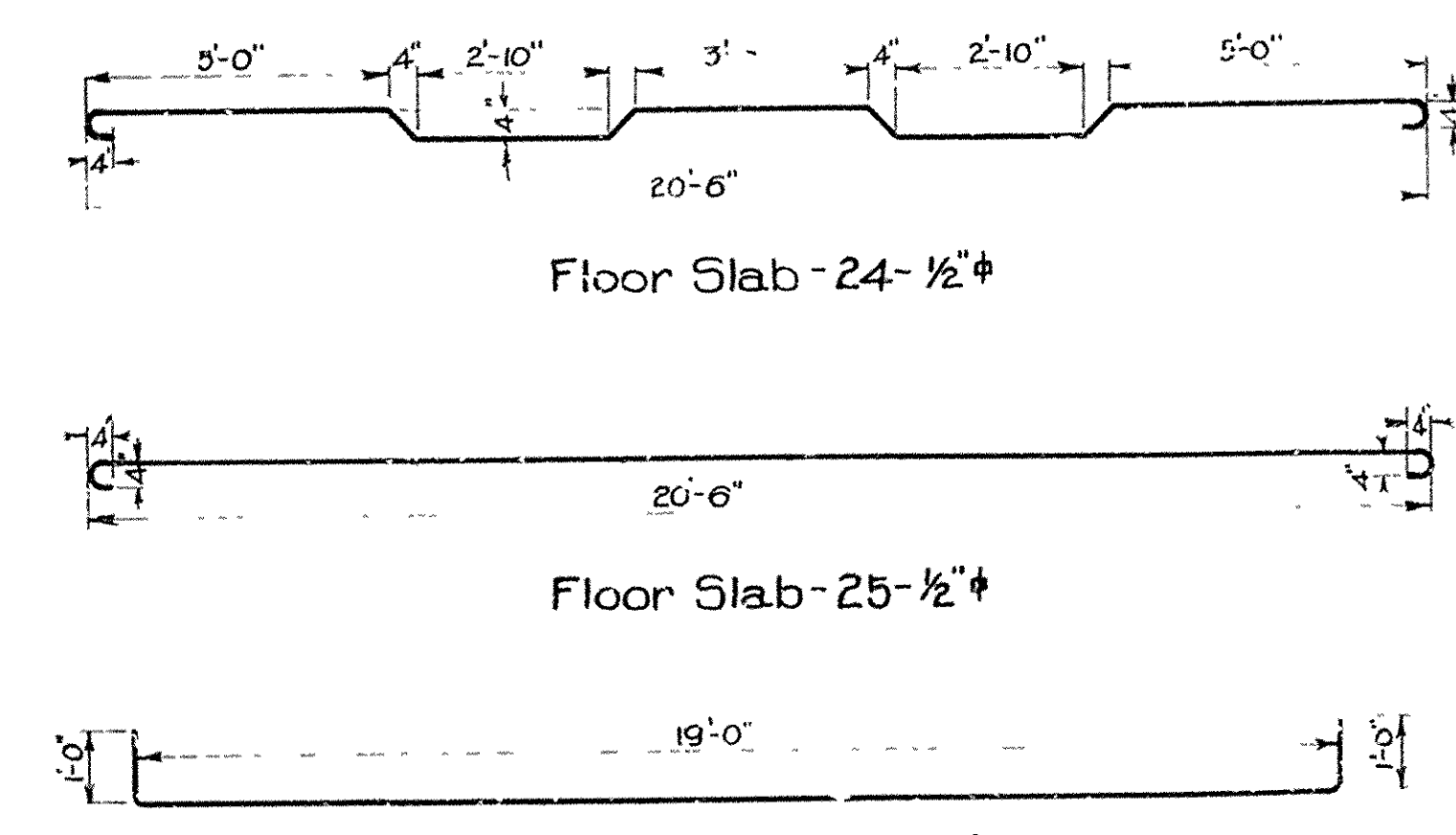
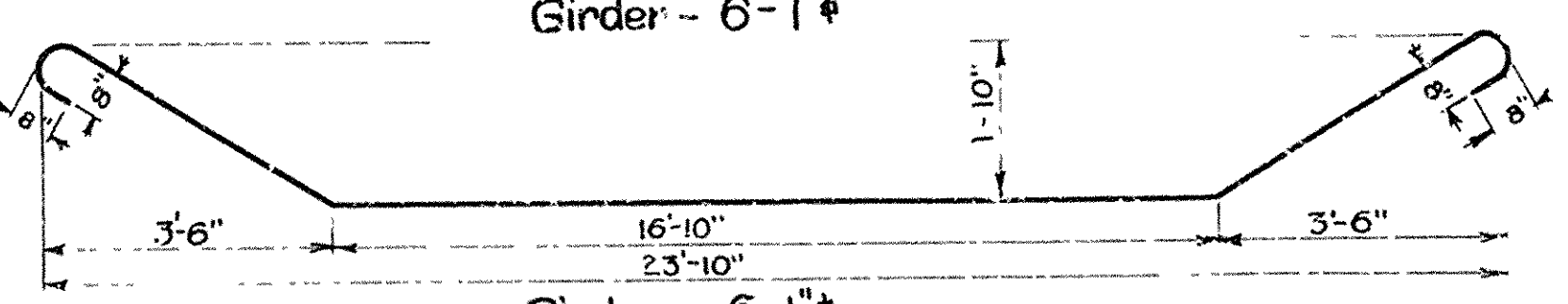
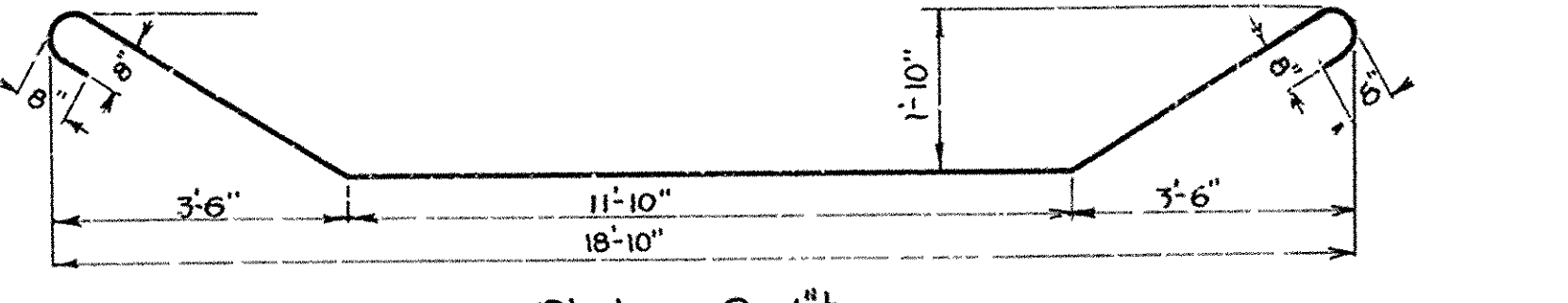
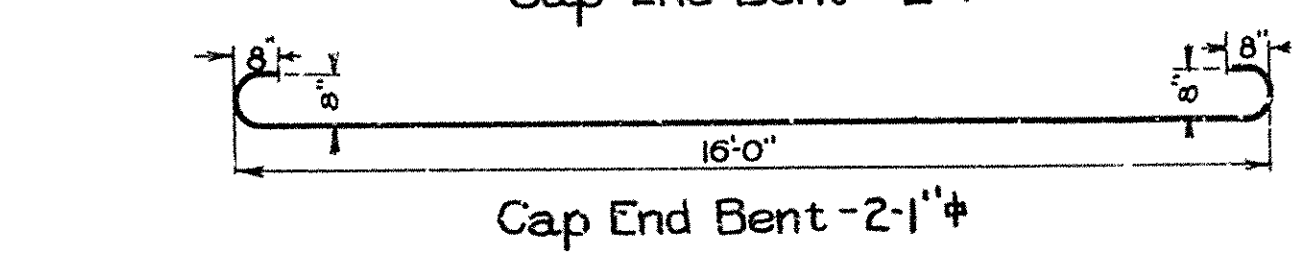
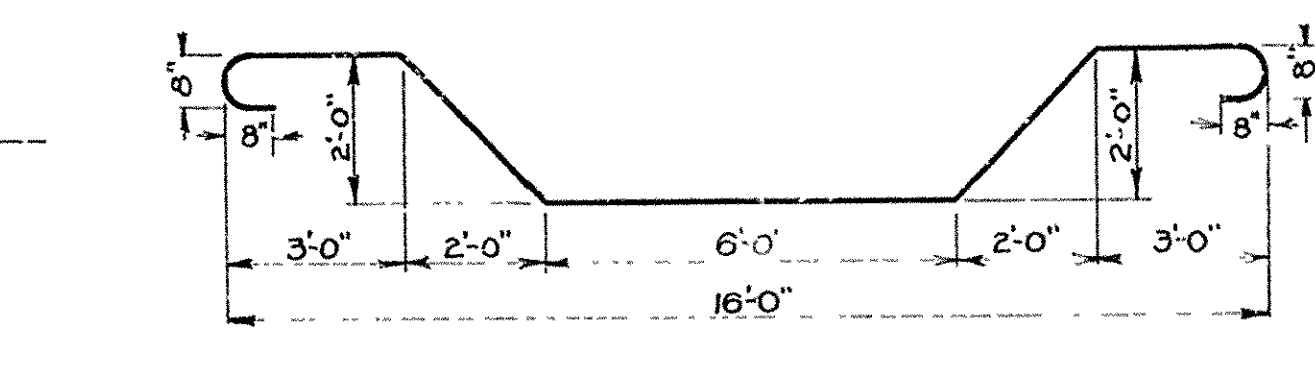
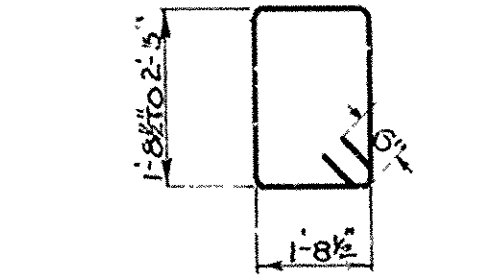
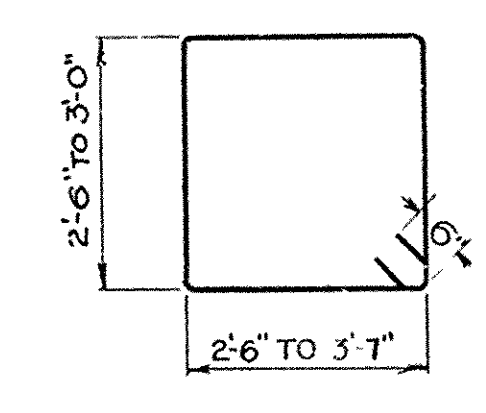
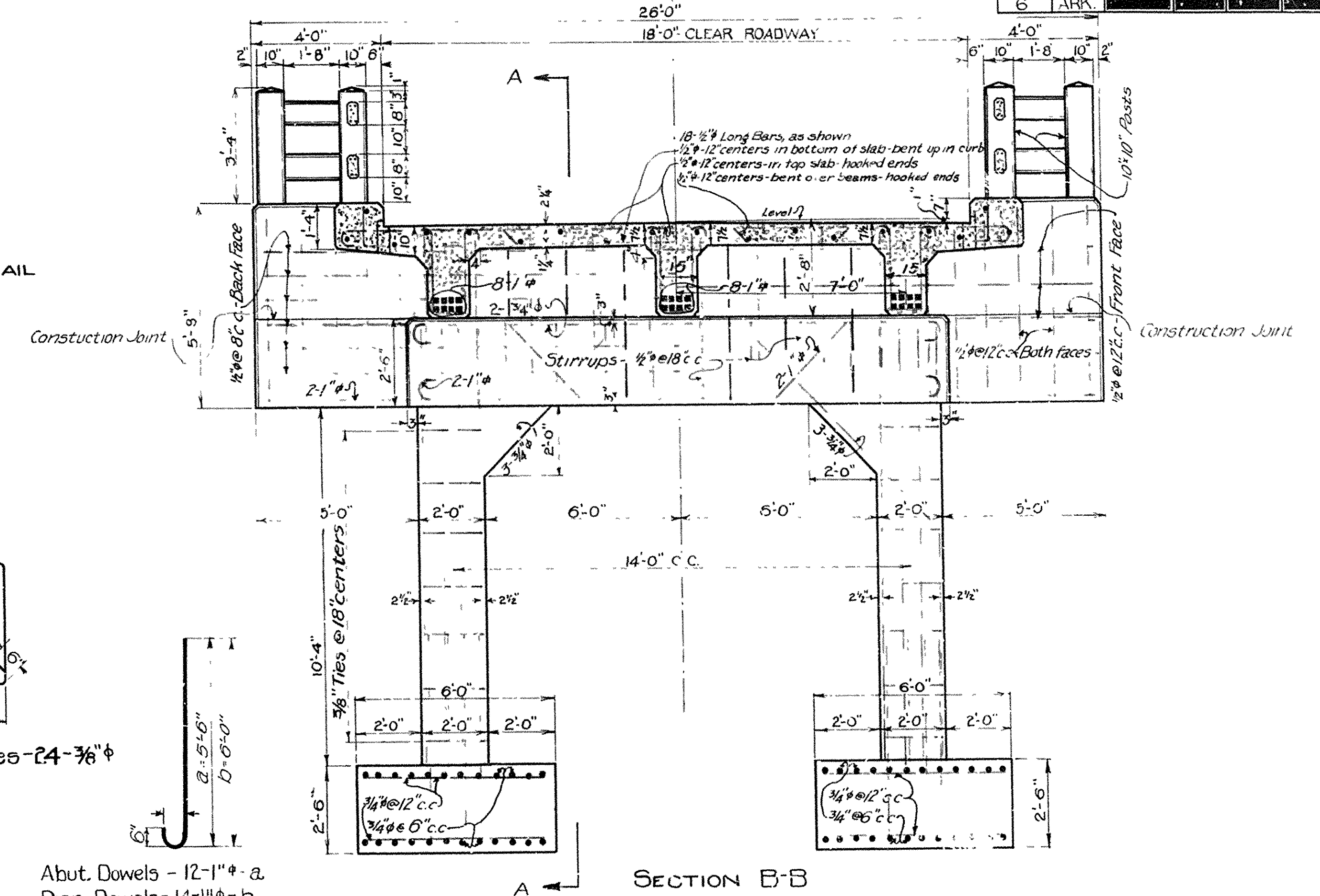
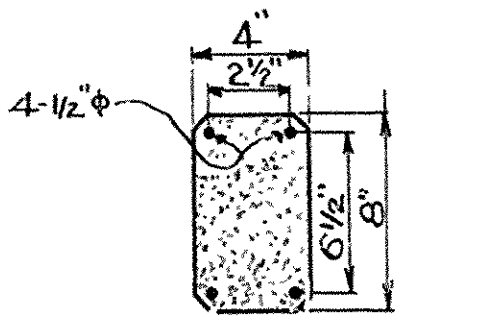
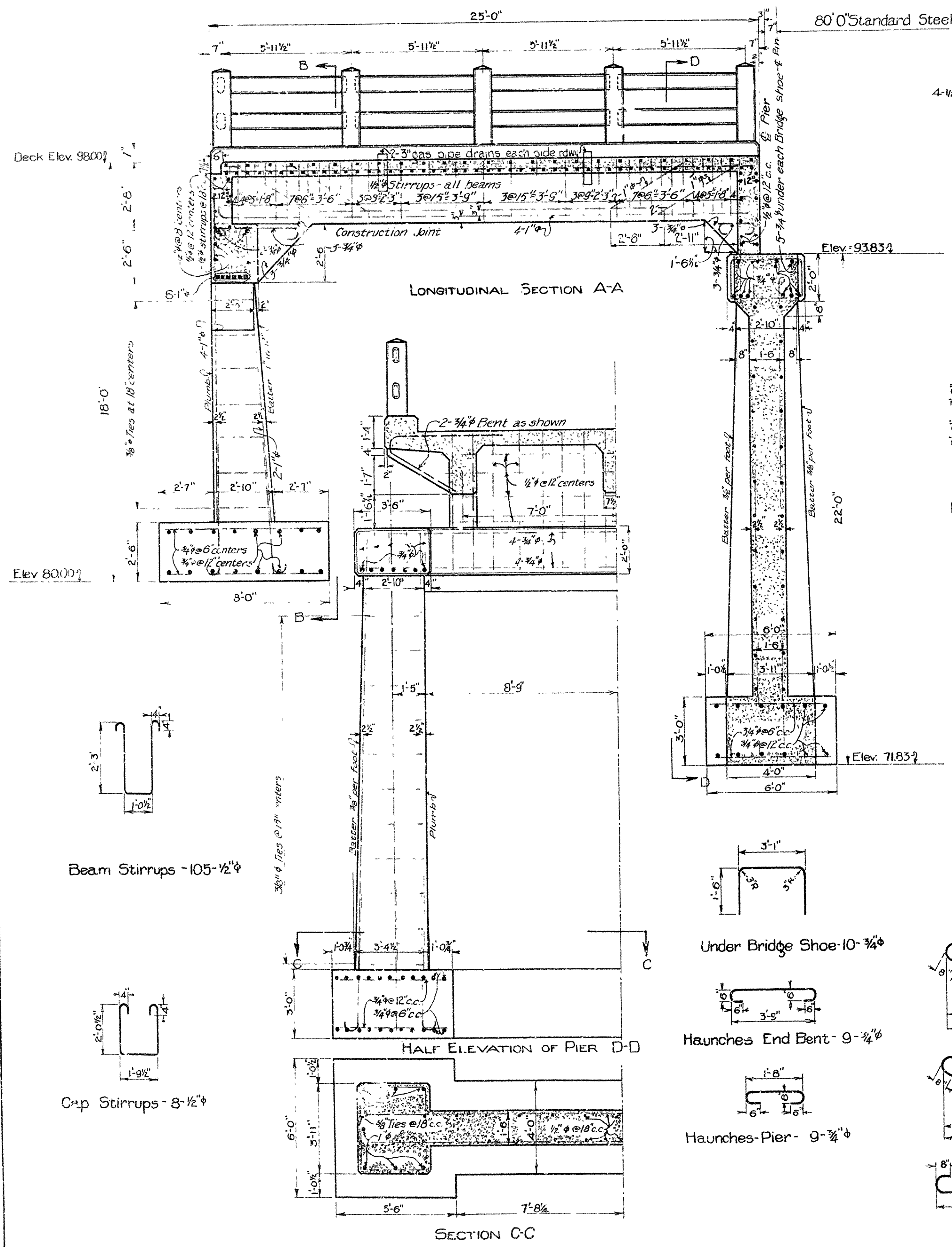

FOR NOTES: See drawing No. 342

DETAILS OF EAST APPROACH
BRIDGE OVER GREENBRIER CREEK
 6 MILES W. OF BATESVILLE, INDEPENDENCE CO. STATE HIGHWAY NO. 25
 ARKANSAS STATE HIGHWAY DEPARTMENT
 LITTLE ROCK, ARK.
 Designed By: MWK Date: 8-24-21 Scale: 3/8"=1'
 Traced By: MWV Date: 8-27-21
 Checked By: Date:
 Bridge No. 352 Drawing No. 341

H. B. Harris
BRIDGE ENGINEER